

# Movable Platen

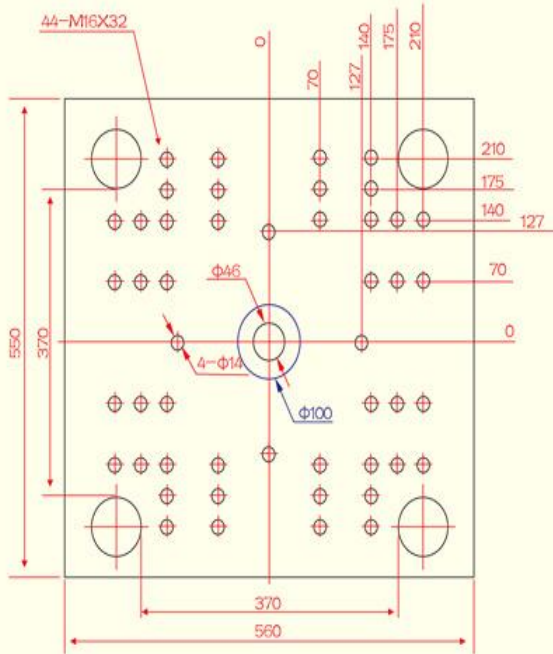

TME50-370

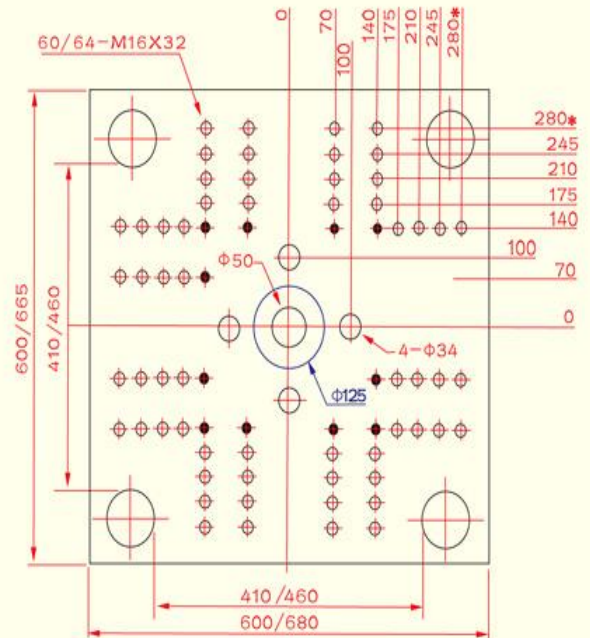

TME75-410/TME110-460  
 ◆ TME75-410适用  
 \* TME110-460适用

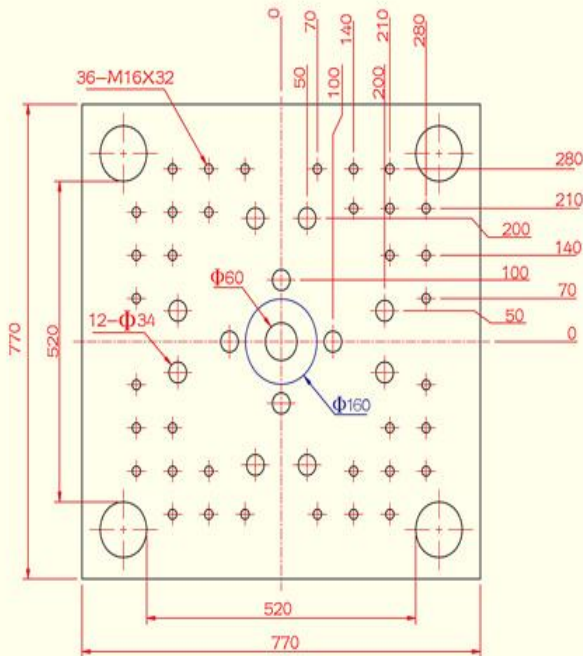

TME150-520

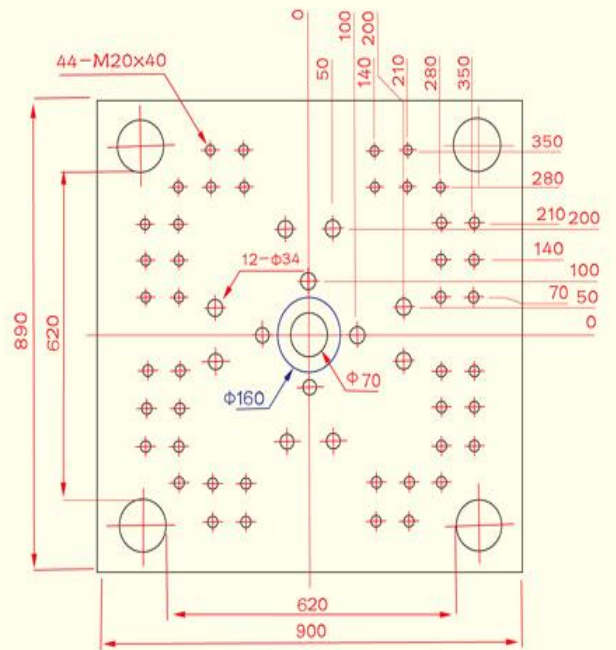

TME200-620

○ Movable platen centering ring

# Movable Platen

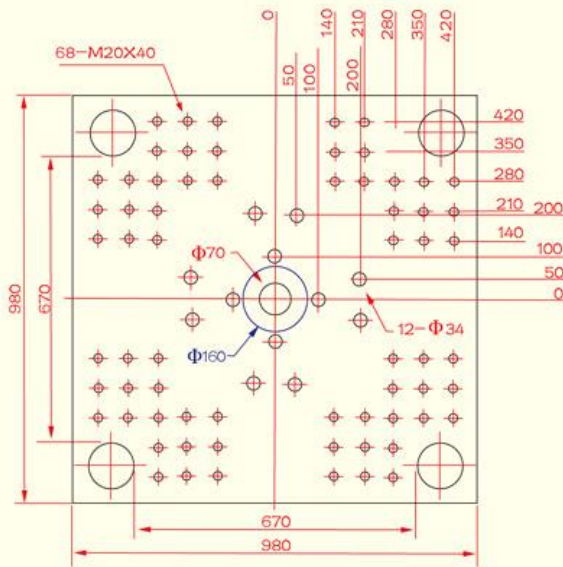

TME250-670

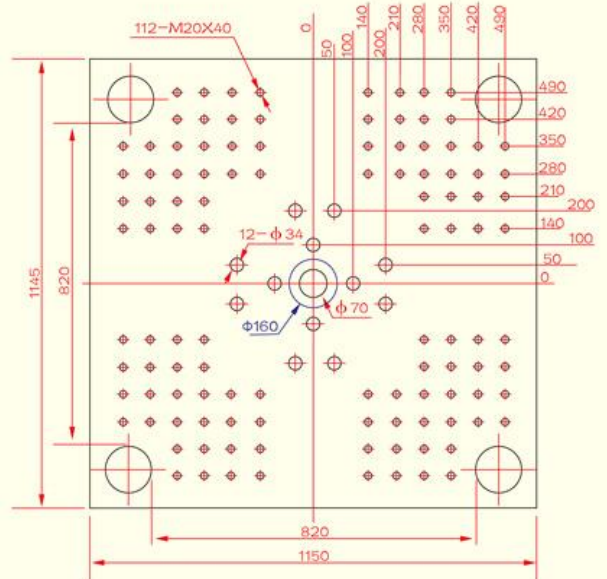

TME350-820

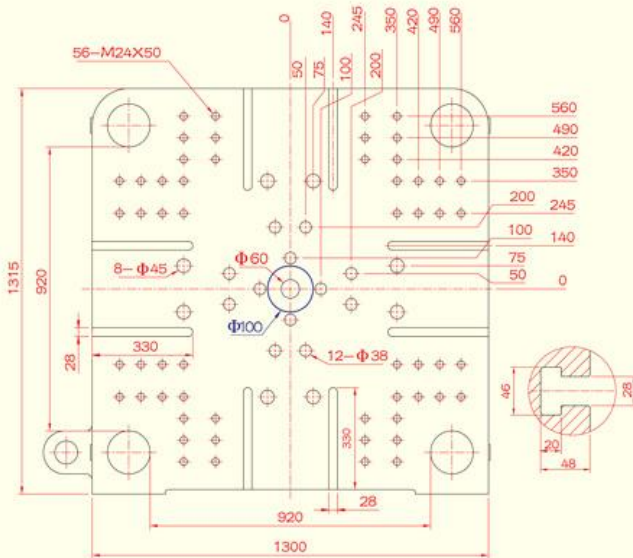

TME450-920

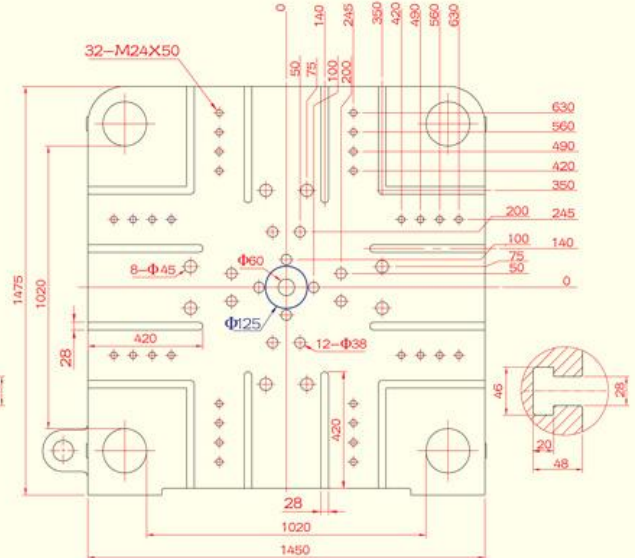

TME550-1020

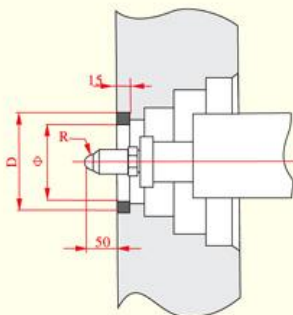

- TME50-370
- TME75-410, TME110-460
- TME150-520, TME200-620, TME250-670
- TME350-820, TME450-920, TME550-1020
- TME50-370, TME75-410, TME110-460
- TME150-520, TME200-620,
- TME250-670, TME350-820, TME550-1020
- TME450-920
- Movable platen centering ring

- D:  $\phi$ 100
- D:  $\phi$ 125
- D:  $\phi$ 160
- D:  $\phi$ 200
- R: R10
- R: R10
- R: R15
- R: R25



## Tat Ming Technology Company Ltd.

Unit 919, Tower A, Regent Centre,  
63 Wo Yi Hop Road, Kwai Chung,  
Hong Kong  
Tel: (852)2790 4633  
Fax: (852)2797 8774  
E-mail: tatming@netvigator.com  
Http://www.tatming.com.cn

Model	TME50-370			TME75-410			TME110-460		
Injection unit size rating	183			267			394		
Clamping unit size rating	50			75			110		
<b>Injection unit</b>									
Screw	A	B	C	A	B	C	A	B	C
Screw diameter (mm)	30	33	36	34	37	41	39	43	47
L/D ratio	24.2	22	20.2	23.9	22	19.9	24.3	22	20.1
Injection volume (cc)	99	120	143	141	167	205	209	254	304
Shot weight (PS)(g)	88	107	127	126	149	183	187	227	271
Shot weight (PS)(oz)	3.1	3.8	4.5	4.4	5.2	6.4	6.6	8	9.5
Injection pressure (kg/cm <sup>2</sup> )	1849	1528	1284	1900	1604	1307	1886	1551	1299
Plasticizing capacity (g/s)	7.6	10.2	13.5	11.6	15.2	20.9	16.9	23	30.3
Injection speed (cm/s)		12.9			12.1			11.6	
Injection rate (cc/s)	91	110	131	109	130	159	139	168	201
Injection stroke (mm)		140			155			175	
Injection time (s)		1.1			1.3			1.5	
Screw rotary speed (rpm)		253			261			246	
Screw torque (kg-m)		65.3			78.3			102.8	
Carriage force (ton)		2.2			3.4			3.4	
Carriage stroke (mm)		181			201			236	
<b>Clamping unit</b>									
Clamping force (ton)		50			75			110	
Opening stroke (mm)		340			378			432	
Min.mould height(mm)		170			180			205	
Max.mould height (mm)		470/630			570/670			595/720	
Max.daylight (mm)		810/970			948/1048			1027/1152	
Clearnce btwn tiebars (hvx)(mmxmm)		370x370			410x410			460x460	
Platen size (hvx)(mmxmm)		560x550			600x600			680x665	
Max.mould length (mm)		670			740			800	
Mould opening force (ton)		34			53			74	
Mould opening speed (cm/s)		63.2			63.3			63.2	
Mould closing speed (cm/s)		43.4			149.5			130.3	
Dry cycle time (s)		1.3			0.8			1.0	
Ejector forward force (ton)		2			3.1			3.9	
Ejector backward force (ton)		1.4			2.2			2.7	
Ejector stroke (mm)		100			130			150	
Ejector forward speed (cm/s)		83.6			66.2			66.3	
Ejector backward speed (cm/s)		120			96			98	
Number of ejector pins		1			5			5	
<b>General</b>									
Motor power (kW)		11.2			14.9			18.6	
Heating power (kW)		7.23			9.88			12.38	
Total current (A)		32.6			44.8			54.3	
Temperature zones		4+1			4+1			4+1	
Oil tank capacity (l)		250			300			330	
Hopper capacity (l)		55			55			55	
System pressure (kg/cm <sup>2</sup> )		160			160			160	
Dimensions(Lxwxh)(mxmxm)		4.0x0.9x1.4			4.55x1.03x1.7			5.33x1.11x1.77	
Weight (ton)		3.5			4			4.5	

Specifications are subject to change without prior notice.

Model	TME150-520			TME200-620			TME250-670		
Injection unit size rating	586			904			1330		
Clamping unit size rating	150			200			250		
<b>Injection unit</b>									
Screw	A	B	C	A	B	C	A	B	C
Screw diameter (mm)	44	49	53	51	56	61	58	64	70
L/D ratio	24.5	22	20.3	24.2	22	20.2	24.3	22	20.1
Injection volume (cc)	304	377	441	470	566	672	700	853	1020
Shot weight (PS)(g)	271	337	394	419	506	600	625	761	910
Shot weight (PS)(oz)	9.6	11.9	13.9	14.8	17.8	21.1	22	26.8	32
Injection pressure (kg/cm <sup>2</sup> )	1927	1553	1328	1923	1595	1344	1900	1561	1304
Plasticizing capacity (g/s)	19.8	27.8	35.4	37.4	50	65.2	41.8	56.7	74.7
Injection speed (cm/s)		8.9			9.5			7.4	
Injection rate (cc/s)	136	168	197	194	234	278	196	239	286
Injection stroke (mm)		200			230			265	
Injection time (s)		2.2			2.4			3.6	
Screw rotary speed (rpm)		198			236			177	
Screw torque (kg-m)		128.9			155.1			205.7	
Carriage force (ton)		5.5			5.5			8.6	
Carriage stroke (mm)		261			281			316	
<b>Clamping unit</b>									
Clamping force (ton)		150			200			250	
Opening stroke (mm)		484			572			638	
Min.mould height(mm)		235			270			310	
Max.mould height (mm)		680/780			710/850			775/925	
Max.daylight (mm)		1164/1264			1282/1422			1413/1563	
Clearnce btwn tiebars (hvx)(mmxmm)		520x520			620x620			670x670	
Platen size (hvx)(mmxmm)		770x770			900x890			980x980	
Max.mould length (mm)		970			1030			1070	
Mould opening force (ton)		101			137			173	
Mould opening speed (cm/s)		51.4			43			35.1	
Mould closing speed (cm/s)		106.1			96.4			76.9	
Dry cycle time (s)		1.4			1.9			2.6	
Ejector forward force (ton)		5.0			7.1			8	
Ejector backward force (ton)		3.4			5.1			5.5	
Ejector stroke (mm)		175			190			235	
Ejector forward speed (cm/s)		52.4			57.3			46.4	
Ejector backward speed (cm/s)		78			83			68	
Number of ejector pins		13			13			13	
<b>General</b>									
Motor power (kW)		18.6			22.4			29.8	
Heating power (kW)		14.84			20.81			25.1	
Total current (A)		58			73.2			94.8	
Temperature zones		4+1			4+1			5+1	
Oil tank capacity (l)		360			500			550	
Hopper capacity (l)		58			72			72	
System pressure (kg/cm <sup>2</sup> )		160			160			160	
Dimensions (lwxh)(mxmxm)		5.85x1.18x1.83			6.5x1.2x1.90			7.4x1.4x1.95	
Weight (ton)		7			9.5			12	

Specifications are subject to change